

# McKissick® Roller Bearing Sheaves

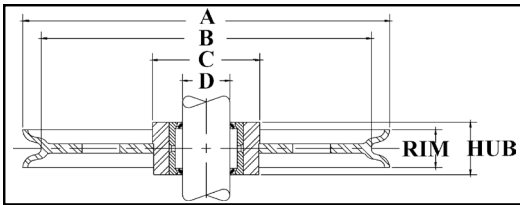

**SEE APPLICATION AND  
WARNING INFORMATION**

Para Español: [www.thecrosbygroup.com](http://www.thecrosbygroup.com)

on Pages 375-382

McKissick  
Sheaves

## Roller Bearing Sheaves

- Roll-Forged™ sheaves are available in sizes up to 78" in diameter.
- McKissick® Roller Bearing Sheaves are designed to operate on shafts carburized to 60 Rockwell "C" and groove to +/- .0005 of the indicated shaft size. Some sizes are available with an optional inner race. Check with Crosby Sales for prices and correct shaft size.
- Application should provide for 1/32" running clearance over the hub width.
- For sizes not listed, McKissick Finished Bore Sheaves can be equipped with Roller Bearings at an optional charge.

"A" Nominal Outside Diameter (in.)	Stock Number	Pattern Number	Wire Line Size (in.)	"D" Shaft Size (in.)	Hub Width (in.)	Rim Width (in.)	"C" Nominal Hub Outside Diameter (in.)	"B" Nominal Tread Diameter (in.)	Material	Approx. Weight (lbs.)
4	472508	4-1	1/8	.997	1	7/8	2	3-1/8	B.S.	2.00
4	472517	4-1	1/4	.997	1	7/8	2	3-1/8	B.S.	2.00
4	472535	4-1	3/8	.997	1	7/8	2	3-1/8	B.S.	2.00
4	2025893	4-K	3/8	.997	1-1/2	1-3/8	2	3	F.S.	3.50
4	2028063	4-K	1/2	.997	1-1/2	1-3/8	2	3	F.S.	3.50
4	2025891	4-K	5/8	.997	1-1/2	1-3/8	2	3	F.S.	3.50
4-7/8	472768	5-1-B	3/8	1.247	1-1/4	1-1/8	2-1/4	4-1/16	F.S.	3.60
4-7/8	472777	5-1-B	1/2	1.247	1-1/4	1-1/8	2-1/4	4-1/16	F.S.	3.60
4-7/8	472786	5-1-B	5/8	1.247	1-1/4	1-1/8	2-1/4	4-1/16	F.S.	3.60
5-1/4	2026427	6-6	5/8	.997	1-1/2	1-3/8	2-1/16	3-7/8	F.S.	4.00
5-1/4	2026423	6-6	3/4	.997	1-1/2	1-3/8	2-1/16	3-7/8	F.S.	4.00
5-7/8	2023141	6-2	5/8	1.497	1-3/4	1-5/8	2-1/2	4-3/8	F.S.	6.00
5-7/8	2023143	6-2	3/4	1.497	1-3/4	1-5/8	2-1/2	4-3/8	F.S.	6.00
5-7/8	2023142	6-2	7/8	1.497	1-3/4	1-5/8	2-1/2	4-3/8	F.S.	6.00

\* Without Flame Hardening

McKissick® Roll-Forged™ sheaves highlighted above in bold italic are available with reduced lead times due to our advanced manufacturing process.

Custom sheaves are available. See page 281 for ordering details.

# McKissick® Roller Bearing Sheaves

"A" Nominal Outside Diameter (in.)	Stock Number	Pattern Number	Wire Line Size (in.)	"D" Shaft Size (in.)	Hub Width (in.)	Rim Width (in.)	"C" Nominal Hub Outside Diameter (in.)	"B" Nominal Tread Diameter (in.)	Material	Approx. Weight (lbs.)
6	472875	6-8	1/2	1.997	1-3/4	1-1/4	3-1/8	4-3/4	F.S.	7.00
7-1/2	2025898	8-7	5/8	.997	1-1/2	1-3/8	2-1/16	6-5/16	F.S.	7.50
7-1/2	2025892	8-7	3/4	.997	1-1/2	1-3/8	2-1/16	6-5/16	F.S.	7.50
7-5/8	473311	8-10	3/8	.997	1-1/2	1-1/4	2-3/8	6-3/16	D.I.	7.00
7-5/8	473320	8-10	1/2	.997	1-1/2	1-1/4	2-3/8	6-3/16	D.I.	7.00
7-5/8	473339	8-10	5/8	.997	1-1/2	1-1/4	2-3/8	6-3/16	D.I.	7.00
8	2023163	8-2	3/4	1.497	1-3/4	1-5/8	2-9/16	6-5/16	F.S.	10.0
8	2023155	8-2	1/2	1.497	1-3/4	1-5/8	2-9/16	6-5/16	F.S.	10.0
8	2023159	8-2	5/8	1.497	1-3/4	1-5/8	2-9/16	6-5/16	F.S.	10.0
8	2023404	8NS-2	3/4	1.997	2-5/16	2-1/8	3-1/4	6-1/8	F.S.	12.5
9-7/8	2026433	10-2	1/2	1.497	1-3/4	1-5/8	2-9/16	8-5/16	F.S.	14.5
9-7/8	2023179	10-2	5/8	1.497	1-3/4	1-5/8	2-9/16	8-5/16	F.S.	14.5
9-7/8	2023181	10-2	3/4	1.497	1-3/4	1-5/8	2-9/16	8-5/16	F.S.	14.5
9-7/8	2023436	10NS-2	3/4	1.997	2-5/16	2-3/16	3-1/2	8-1/8	F.S.	15.0
12	2023248	12-1	5/8	1.497	1-3/4	1-5/8	3-1/4	10-1/8	F.S.	18.0
12	2023236	12-1	3/4	1.497	1-3/4	1-5/8	3-1/4	9-3/4	F.S.	18.0
12	2026441	12-1	7/8	1.497	1-3/4	1-5/8	3-1/4	10-1/4	F.S.	18.0
12	<b>474365</b>	<b>12-9</b>	<b>5/8</b>	<b>2.247</b>	<b>1-3/4</b>	<b>1-5/8</b>	<b>4-1/2</b>	<b>10-1/8</b>	<b>R.F.</b>	<b>16.0</b>
12	<b>474374</b>	<b>12-9</b>	<b>3/4</b>	<b>2.247</b>	<b>1-3/4</b>	<b>1-5/8</b>	<b>4-1/2</b>	<b>9-3/4</b>	<b>R.F.</b>	<b>16.0</b>
14	<b>2026445</b>	<b>14-1</b>	<b>5/8</b>	<b>1.497</b>	<b>1-3/4</b>	<b>1-5/8</b>	<b>3-1/4</b>	<b>12</b>	<b>R.F.</b>	<b>20.0</b>
14	<b>2026444</b>	<b>14-1</b>	<b>3/4</b>	<b>1.497</b>	<b>1-3/4</b>	<b>1-5/8</b>	<b>3-1/4</b>	<b>11-3/4</b>	<b>R.F.</b>	<b>20.0</b>
14	<b>474784</b>	<b>14-1</b>	<b>7/8</b>	<b>1.497</b>	<b>1-3/4</b>	<b>1-5/8</b>	<b>3-1/4</b>	<b>12-1/4</b>	<b>R.F.</b>	<b>20.0</b>
14	<b>4200563</b>	<b>14-2</b>	<b>5/8</b>	<b>1.997</b>	<b>1-3/4</b>	<b>1-5/8</b>	<b>4-1/2</b>	<b>12-1/8</b>	<b>R.F.</b>	<b>31.0</b>
14	<b>4200572</b>	<b>14-2</b>	<b>3/4</b>	<b>1.997</b>	<b>1-3/4</b>	<b>1-5/8</b>	<b>4-1/2</b>	<b>11-3/4</b>	<b>R.F.</b>	<b>31.0</b>
16	<b>4200705</b>	<b>16-5B</b>	<b>7/8</b>	<b>2.497</b>	<b>2-5/16</b>	<b>2-3/16</b>	<b>4-1/2</b>	<b>12-15/16</b>	<b>R.F.</b>	<b>48.0</b>
18	<b>4201438</b>	<b>18-2</b>	<b>7/8</b>	<b>2.747</b>	<b>2-5/16</b>	<b>2-3/16</b>	<b>5-1/2</b>	<b>14-15/16</b>	<b>R.F.</b>	<b>42.7</b>
18	<b>4200867</b>	<b>18-2</b>	<b>1</b>	<b>2.747</b>	<b>2-5/16</b>	<b>2-3/16</b>	<b>5-1/2</b>	<b>14-7/8</b>	<b>R.F.</b>	<b>66.0</b>
20	<b>4200929</b>	<b>20-2</b>	<b>1</b>	<b>2.997</b>	<b>2-5/16</b>	<b>2-3/16</b>	<b>5-1/2</b>	<b>16-1/2</b>	<b>R.F.</b>	<b>77.0</b>
24	<b>4200117</b>	<b>24-1A</b>	<b>1</b>	<b>2.247</b>	<b>2-1/2</b>	<b>2-3/8</b>	<b>5-1/2</b>	<b>21-1/8</b>	<b>R.F.</b>	<b>75.0</b>

\* Without Flame Hardening

Material: B.S.=Bar Steel, C.I.=Cast Iron, F.S.=Forged Steel, D.I.=Ductile Iron, C.S.=Cast Steel, P.M.=Powdered Metal, R.F.=Roll-Forged™.

McKissick® Roll-Forged™ sheaves highlighted above in bold italic are available with reduced lead times due to our advanced manufacturing process.