

Bronze Bushed Sheaves

54" and larger diameters available on request.

*Material: C.I. – Cast Iron / D.I. – Ductile Iron / S. – Steel / C.S. – Cast Steel / F.F. – ForgeFab™

ForgeFab™ will furnish sheaves to specified wire rope size within the minimum and maximum wire rope size indicated, at no additional charge.

When Ordering Please Specify:

·Nominal Sheave O.D. ·Model Number ·Wire Rope Size

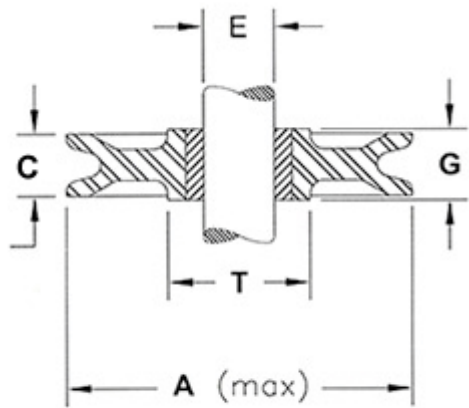

BRONZE BUSHED SHEAVE

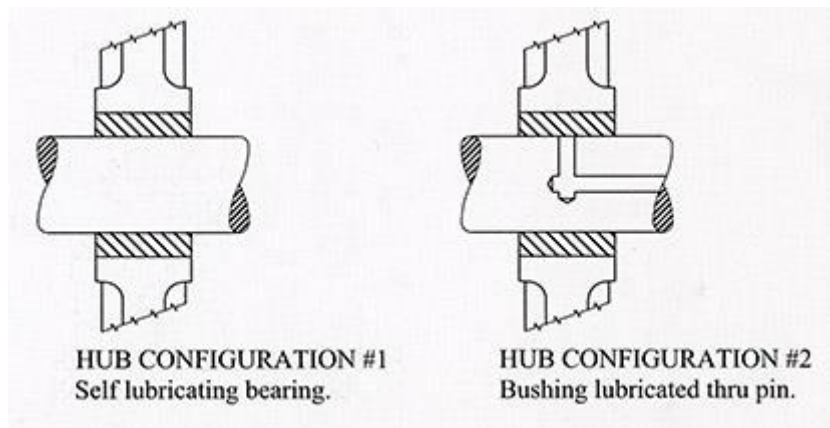

Model Number	Part Number	Wire Rope Range				Material	Weight		A Outside Diameter Max Dia	C Rim Width Maximum	E Shaft	G Assembly Width Maximum	T Hub Outside Diameter Nominal
		Minimum		Maximum			Pounds						
		inch	(mm)	inch	(mm)								
3-2-SB		1/4	6.5	0.500	13.000	STEEL	1	1	3.02	0.92	0.750	1.050	1.60
HFMR	452501	1 1/4	32.0	1.250	32.000	Ductile Iron	1	4	3.70	1.44	1.000	1.508	1.81
HFWR	452100	3/8	9.5	0.875	22.000	Ductile Iron	1	4	4.25	1.44	1.000	1.508	1.81
4-3	452502	1/4	6.5	0.750	19.000	Ductile Iron	2	3	4.50	1.43	1.000	1.565	2.00
4.5-3-SB		1/2	13.0	0.500	13.000	P. M.	2	5	4.52	1.40	1.000	1.565	2.00
6-5-1	452506	1/4	6.5	1.000	26.000	Ductile Iron	2	6	5.87	1.50	1.250	1.635	3.13
6-5	452505	1/4	6.5	1.000	26.000	Ductile Iron	2	6	5.87	1.50	1.500	1.625	3.13
6-10	452507	3/8	9.5	1.125	29.000	Ductile Iron	2	8	5.87	1.76	2.000	2.000	4.00
WL-61-B	452503	1/4	6.5	0.625	16.000	Ductile Iron	1	4	6.00	1.06	0.750	1.125	2.25
6-10	452507	9/16	14.5	0.563	14.500	Ductile Iron	2	8	6.00	1.76	2.000	2.000	4.00
6-3	452504	3/16	14.5	1.000	26.000	Ductile Iron	2	6	6.12	1.44	1.000	1.565	2.75
6.3-10		1/2	13.0	0.875	22.000	Ductile Iron	2	9	6.25	1.76	2.000	2.000	4.00
8-5-1	452512	3/8	9.5	1.000	26.000	Ductile Iron	2	11	7.87	1.50	1.250	1.635	3.13
8-5	452511	5/16	8.0	1.000	26.000	Ductile Iron	2	11	7.87	1.50	1.500	1.625	3.13
8-10	452513	3/8	9.5	1.250	32.000	Ductile Iron	2	14	7.87	1.80	2.000	2.000	4.00
7.9-10-1		7/8	22.0	1.000	26.000	Ductile Iron	2	14	7.87	1.75	2.500	2.000	4.00
WL-81-A	452509	5/16	8.0	0.750	19.000	Ductile Iron	1	7	8.00	1.31	0.875	1.375	2.50
8-3	452508	1/4	6.5	0.875	22.000	Ductile Iron	2	7	8.00	1.50	1.000	1.565	2.50

